



Series 75

Straight Sliding and Conveyor System

The Series 75 is the perfect option for lightweight doors or overhead runways.

Manufactured from A4/316 grade stainless steel the Series 75 is perfect for use in hygiene-sensitive environments, as well as in harsh weather conditions and salt water exposure.



Suitable for panels up to 75kg.



Featuring high quality components



Full technical support



Easy to fit

A4
316 Grade

Manufactured from A4/316 grade stainless steel



Dependable, durable components that are suited to harsh conditions.

Series 75 Components

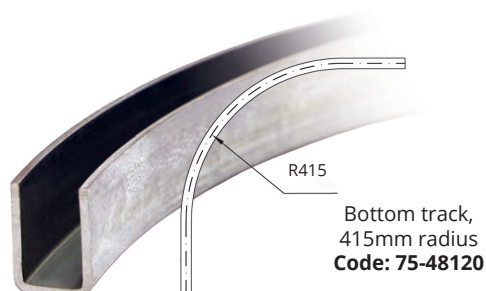
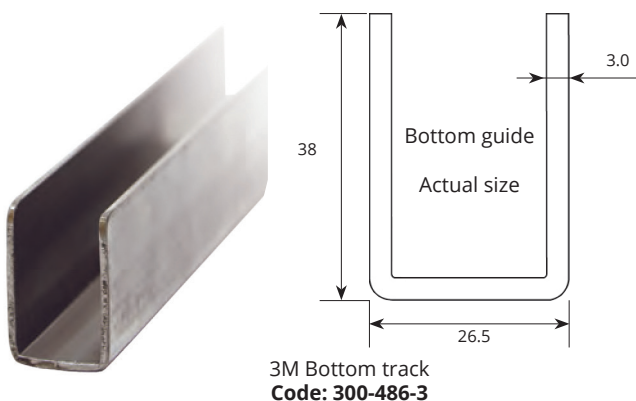
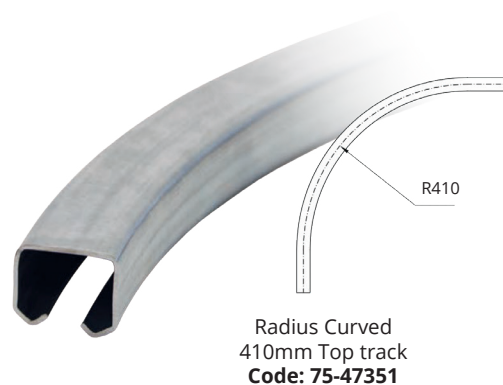
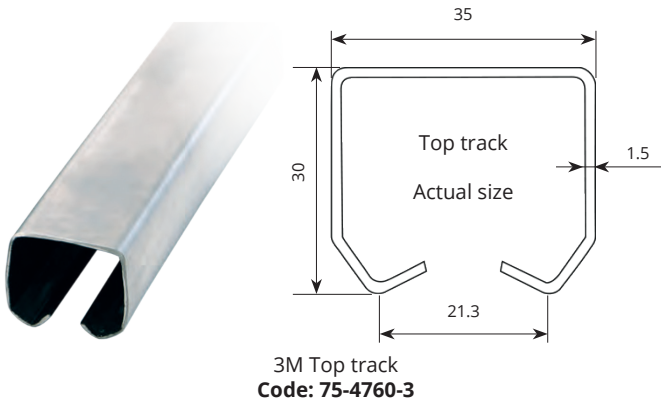

Series 75 Components

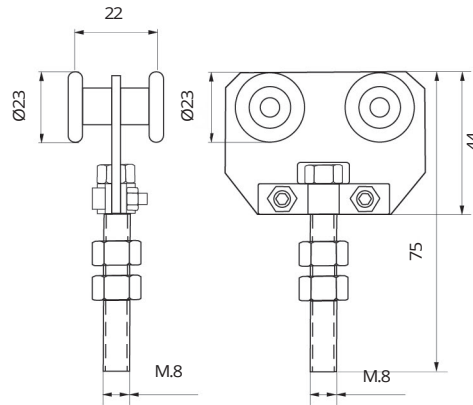

Double axle hanger
37.5kg capacity
Code: 75-4641

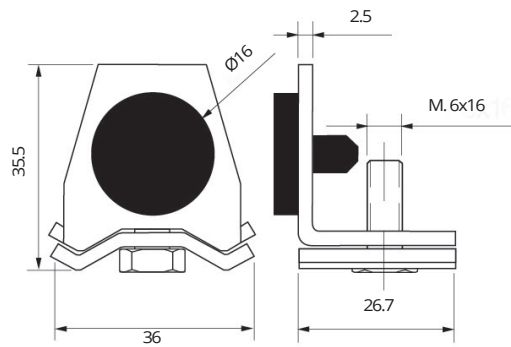

Door stop
Code: 75-47312

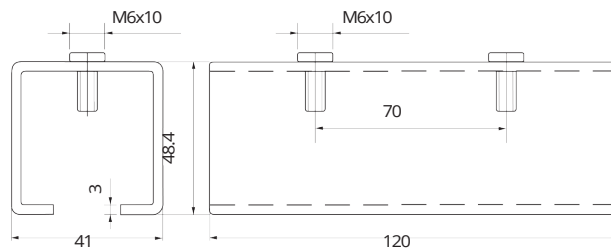

Track connector
Code: 75-47311

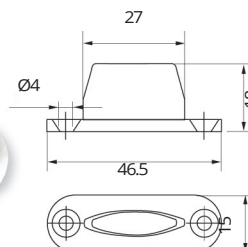

Lower nylon guide
Code: TS-NG

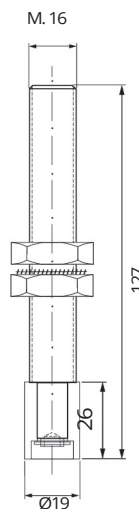

Bottom guide roller with thread
Code: 300-791



Use Polyester resin
to support your
anchor studs and bolts
into hollow walls,
masonry and
concrete floors
Code: AFJ350