



The Series 450 is suited to heavier doors which are used in hygiene-sensitive environments, as well as in harsh weather conditions and salt water exposure.

All the brackets, components, door tracks and channels are manufactured from high grade stainless steel, resulting in excellent corrosion protection of sliding door assets over many years.

## Series 450

### Straight Sliding and Conveyor System



Suitable for panels up to 450kg.



Featuring high quality components



Full technical support



Easy to fit

A4  
316 Grade

Manufactured from A4/316 or 304 grade\* stainless steel



Dependable, durable components that are suited to harsh conditions.

\*Straight and curved top track only available in 304 grade.

## Series 450 Track components

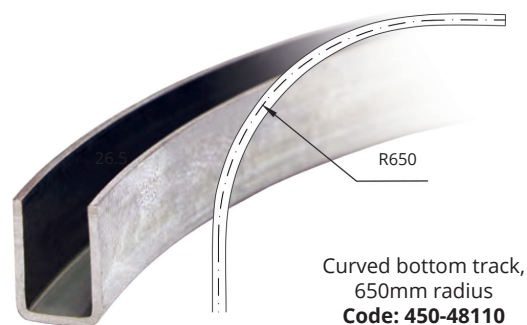
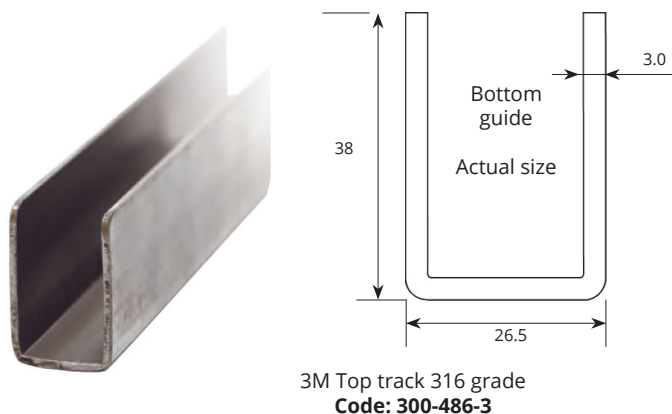
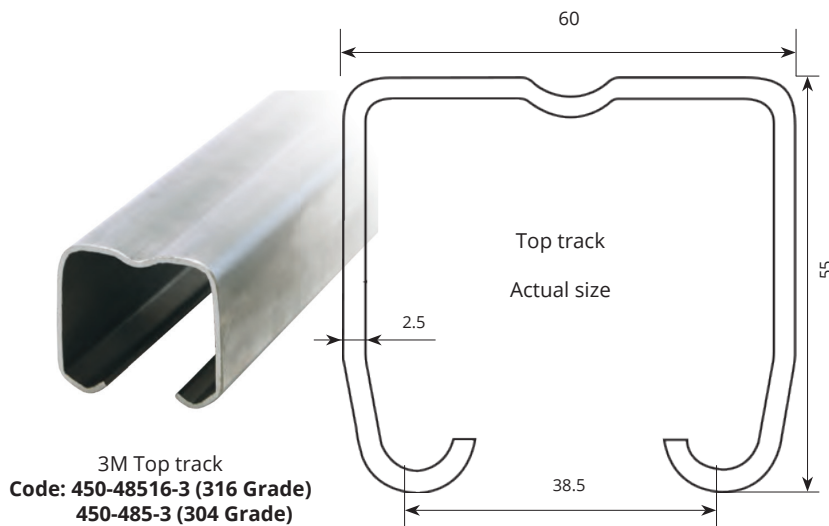

## Series 450 Hangers & rollers

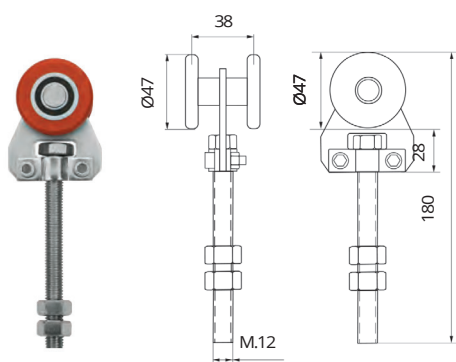

Single axle 120kg capacity  
**Code: 450-483**

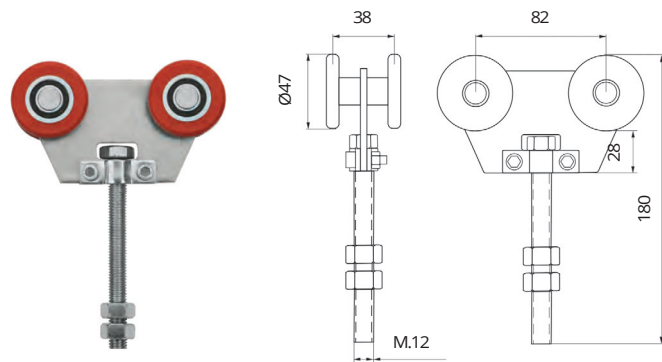

Double axle 225kg capacity  
**Code: 450-484**

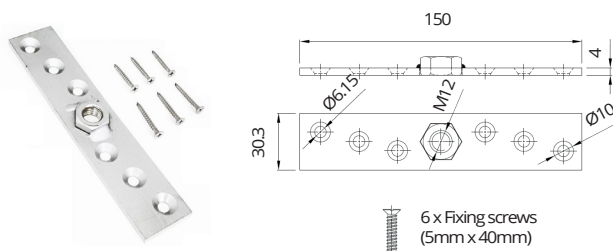

Grade suspension plate set for  
wooden doors, pair  
**Code: 450-46011**

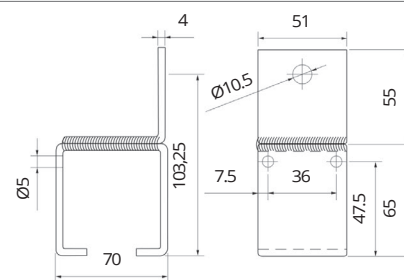

Face fix  
bracket  
**Code: 450-47950**

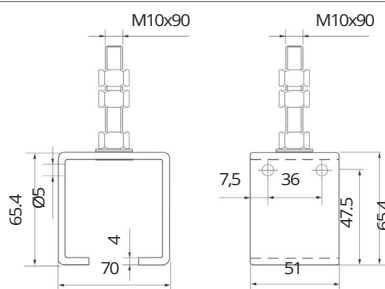

Adjustable bracket  
**Code: 450-47960**

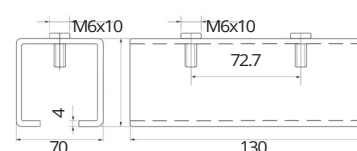

Top track connector  
**Code: 450-47911**

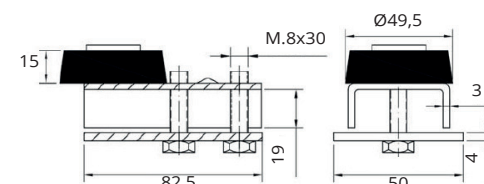

Track  
mounted door stop  
**Code: 450-47501**

## Series 450 Guides

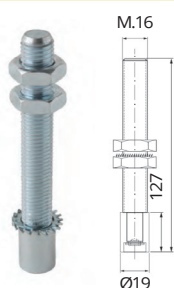

Bottom guide roller  
with thread  
**Code: 300-791**



Lower nylon guide  
**Code: TS-NG**

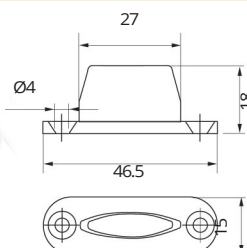

Use Polyester resin  
to support your  
anchor studs and bolts  
into hollow walls,  
masonry and  
concrete floors  
**Code: AFJ350**